

# Hina Dolls of the Mitsui Family

Thematic Exhibition  
The Mitsui Families and Noh

## LIST OF EXHIBITS

February 10, 2018 - April 8

 Mitsui Memorial Museum

### ROOM 1

No.	Title	Artist	Period	
T1	Vase with handles, Oranda ware			17th c.
T2	Clam shell incense container, given by Tōfukumon-in	Kanō Einō	Edo period	17th c.
T3	Incense case in shape of Hōju (Sacred pearl), overglaze enamels and gold	Eiraku Hozen	Edo period	19th c.
T4	Round kettle	Yojirō	Momoyama period	16th c.
T5	Katatsuki tea caddy, named "Futari-Shizuka", Seto ware		Edo period	17th c.
T6	Black lacquered tea container with spring field design in gold	Shunsai	Edo period	19th c.
T7	Square fresh water jar with dragon roundel design, Aka-e type		Ming dynasty	17th c.
T8	Water jar in hand pail shape with design of Sakura-gawa in <i>maki-e</i>	Nakamura Sōtetsu VII	Edo period	19th c.
T9	Tea bowl, Gohon type, named "Momo"		Choson dynasty	17th c.
T10	Tea bowl, named "Eboshi", Black Raku ware	Raku Sōnyū	Edo period	17-18th c.
T11	Tea bowl with scales design in overglaze enamels	Ninsei	Edo period	17th c.
T12	Tea bowl with seashore design, Shonzui type		Ming dynasty	17th c.
T13	Tea bowl with phoenix design in gold, Tenmoku type	Eiraku Wazen	Meiji period	19th c.

**ROOM 2**

T14	Tea bowl, named "Kasumi", Totoya type		Choson dynasty	16th c.
-----	---------------------------------------	--	----------------	---------

**ROOM 3**

T15	Ono no Komachi	Kanō Naonobu	Edo period	17th c.
T16	Tea bowl, Goshomaru type		Choson dynasty	17th c.

**ROOM 4**

Tomoe Symbol Hina Dolls and Miniature Furniture  
Possessed by Mitsui **Motoko** (wife of Takamine, 10th Head of the Kita Mitsui Family)

H1	Standing Hina dolls		Edo period	19th c.
H2	Standing Hina dolls		Edo period	1815
H3	Set of Hina dolls ( <i>Kyōhō-bina</i> )		Edo period	19th c.
H4	Set of Hina dolls ( <i>Dairi-bina</i> )	Ōki Heizō III	Meiji period	1895
H5	Set of Hina dolls ( <i>Yūsoku-bina</i> )	Ōki Heizō IV	Meiji period	19-20th c.
H6	Set of miniature furniture for the Doll's Festival, plum and hawk feathers crest scroll design		Edo period	19th c.

Ei Symbol Hina Dolls and Miniature Furniture  
donated by Ms. **Asano Hisako** (daughter of Takakimi, 11th Head of the Kita Mitsui Family)

H7	Set of Hina dolls and miniature furniture for the Doll's Festival	Ōki Heizō V	Shōwa period	1934
----	---	-------------	--------------	------

Kochō Symbol Hina Dolls and Miniature Furniture  
Possessed by Mitsui **Toshiko** (wife of Takakimi, 11th Head of the Kita Mitsui Family)

H8	Set of miniature furniture for the Doll's Festival, peony scroll design		Meiji-Taishō periods	20th c.
H9	Set of Hina dolls and miniature furniture	Eitokusai II	Meiji-Taishō periods	20th c.
H10	Court lady with her dog	Ōki Kijūrō	Meiji-Taishō periods	20th c.

## ROOM 5

### Tama Symbol Hina Dolls and Miniature Furniture

Possessed by Mitsui **Okiko** (wife of Takahisa, 9th Head of the Isarago Mitsui Family / daughter of Takamine and Motoko)

H11	Set of Hina dolls and miniature furniture	Ōki Heizō IV	Meiji period	1900
H12	Set of miniature furniture for the Doll's Festival, peony scroll design		Meiji period	20th c.
H13	Set of Hina dolls ( <i>Dairi-bina</i> )	Kawabata Gyokuzan	Meiji period	1900
H14	Three gods of waka poem ( <i>Waka-sanjin</i> )	Kawabata Gyokuzan	Meiji period	1900
H15	<i>Kochō</i> , traditional Japanese dance		Meiji period	1896
H16	Court lady		Meiji period	19-20th c.
H17	Beauty holding flower basket		Meiji period	1900
H18	Standing beauty	Ōki Heizō IV	Meiji period	1909
H19	<i>Hōkoku</i> dance	Ōki Heizō IV	Meiji period	1898
H20	Playing children		Meiji period	19-20th c.

### Tomoe Symbol Hina Dolls and Miniature Furniture

Possessed by Mitsui **Motoko** (wife of Takamine, 10th Head of the Kita Mitsui Family)

H21	<i>Gosho-ningyō</i> doll		Edo period	1858
H22	Boxes for shell matching game set with design of Sumiyoshi in <i>Maki-e</i>		Edo period	18th c.

## ROOM 6

### Ei Symbol Hina Dolls and Miniature Furniture

donated by **Ms. Asano Hisako** (daughter of Takakimi, 11th Head of the Kita Mitsui Family)

H23	Miniature toys		Meiji-Shōwa periods	20th c.
-----	----------------	--	---------------------	---------

[Floor guide]

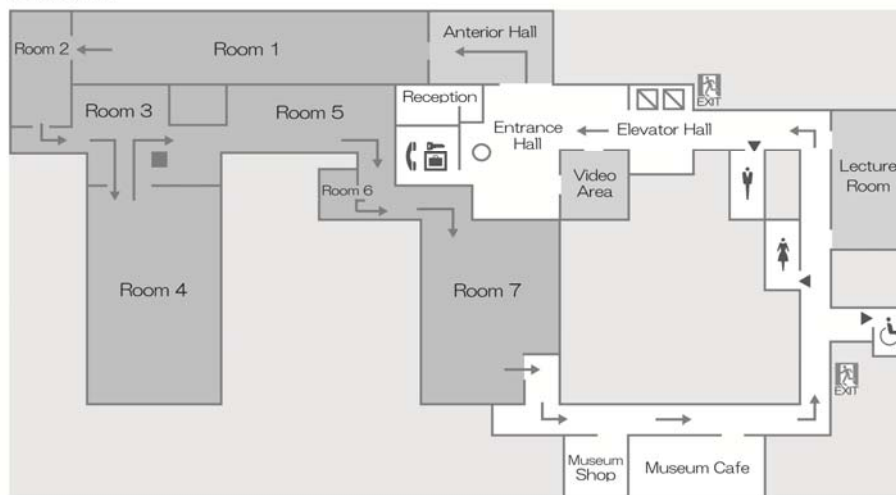

N1	Related materials of Mitsui Takamine			
N2	Related materials of Noh study group, Yō-wa kai			
N3	Related materials of the opening Noh stage at Mitsui residence in Azabu Imaichō		Meiji period	1908
N4	Water pail for Noh play "Matsukaze"	Kawabata Gyokushō	Meiji period	19th c.
N5	Okina (Hakushiki-jyō)		Edo period	
N6	<i>Okina Kariginu</i> , Shokkō geometric pattern		Edo-Meiji periods	19th c.
N7	<i>Sobatsugi</i> , design of fire, clouds and dragons on navy ground		Meiji period	19th c.
N8	Materials related to invitation of Prince of Wales		Taishō period	1922
N9	Prince of Wales and Prince Higashifushimi Yorihiro viewing Noh performance	Fujiwara Nagahira	Taishō period	20th c.
N10	<i>Atsuta Karaori</i> , design of poppies, butterflies and net pattern on red ground		Meiji period	20th c.
N11	<i>Karaori</i> , design of autumn plants on brownish-gray ground		Meiji period	19th c.
N12	Related materials of Mitsui Takakimi and Toshiko			
N13	◎ Shōjyō	Kongō Yorikatsu	Edo period	
N14	◎ Kojō (Koushi-jō)	Attributed to Koushi	Muromachi period	
N15	◎ Shikami	Attributed to Shakuzuru	Muromachi period	
N16	◎ Zo-onna	Attributed to Zōami	Muromachi-Edo periods	
N17	Nohkan (Japanese flute), named "Kojishi"/ Maki-e lacquer case with dragons design	Attributed to Gichiku	Edo period	
N18	Maki-e lacquer hand drum body with musical instrument design, Ko-tsuzumi type	Attributed to Chigusa	Edo period	
N19	Maki-e lacquer hand drum body with arrow case and gun design, O-tsuzumi type, named "Taihei-maru"	Attributed to Ori-i	Momoyama-Edo periods	
N20	Chūkei (fan), design of shower on green paddy field and rainbow	Tosa Mitsubumi	Edo-Meiji periods	19th c.
N21	<i>Karuta</i> (playing cards) featuring scenes from Noh performances		Edo-Meiji periods	19th c.

Coming up next

SPECIAL EXHIBITION ON THE 200TH ANNIVERSARY OF HIS DEATH

**MATSUDAIRA FUMAI: DAIMYO, TEA MASTER, AESTHETE****April 21 - June 17****Mitsui Memorial Museum**

Mitsui Main Building 7F, Nihonbashi Muromachi 2-1-1, Chuo-ku, Tokyo