

SPECIAL EXHIBITION

Giving Form to Buddhist Deities: Emotions, Adornments, Movements

LIST OF EXHIBITS

September 15, 2018 - November 25

Mitsui Memorial Museum



◎ Important Cultural Property

ROOM 1

No.	Title	Artist	Period	Collection
1-1	Standing Karyōbinga (Kalavinka)		Muromachi period, 15th c.	Private collection
1-2	Standing Nyorai (Tathagata)		Kamakura period, 13th c.	Private collection
1-3	◎ Standing Attendants of Shitennō (Caturmaharaja, Attendant of Tōhō-ten, Attendant of Nanpō-ten)	Kōen	Kamakura period, 1267	Tokyo National Museum
1-4	◎ Standing Bosatsu (Bodhisattva)		Asuka period, 7th c.	Tokyo University of the Arts
1-5	◎ Standing Yakushi Nyorai (Bhaisajyaguru)		Nara period, 8th c.	Shōju Raigō-ji temple, Shiga
1-6	Standing Kannon (Avalokitesvara) and Seishi (Mahasthamaprapta) Bosatsu		Kamakura period, 13th c.	Shōmyōj-ji temple, Kanagawa
1-7	◎ Seated Bosatsu (Bodhisattva)		Heian period, 9th c.	Rinsen-ji temple, Gifu
1-8	◎ Standing Eleven-headed Kannon (Avalokitesvara)		Heian period, 9th c.	Seko, Mie
1-9	Seated Bosatsu (Bodhisattva)		Heian period, 12th c.	Private collection

ROOM 2

No.	Title	Artist	Period	Collection
2-1	Standing Fudō Myō-ō (Acalanatha)		Kamakura period, 13th c.	Private collection

ROOM 3

Explanatory Display Tools and materials for Kirikane decorative techniques

Special Display Joan Tearoom arrangement by private collection

- ▲ Designated Cultural Property of Higashi-Ōmi City
- Designated Cultural Property of Ōmi Hachiman City
- ★ Designated Cultural Property of Saitama Prefecture

ROOM 4

4-1	◎ Standing Bishamonten (Vaisravana)		Heian period, ca. 1162	Tokyo National Museum
4-2	◎ Standing Jizō Bosatsu (Ksitigarbha)	Kaijō	Kamakura period, 1256	Shungaku-ji temple, Nara
4-3	Standing Amida Nyorai (Amitabha)		Kamakura period, 13th c.	Tokyo National Museum
4-4	◎ Standing Amida Nyorai (Amitabha)		Kamakura period, 13th c.	Kannon-ji temple, Shiga
4-5	Standing Miroku Bosatsu (Maitreya)		Kamakura period, 13th c.	Private collection
4-6	◎ Amida Nyorai (Amitabha) and Two Attendants		Heian period, 9th c.	Shitennō-ji temple, Osaka
4-7	Standing Bishamonten (Vaisravana)	Higo Jōkei	Kamakura period, 1224	Tokyo University of the Arts
4-8	Standing Bishamonten (Vaisravana)		Heian period, 12th c.	Saiyū-ji temple, Shiga
4-9	Standing Bishamonten (Vaisravana)		Kamakura period, 13th c.	Private collection
4-10	Standing Tenbu (Deva)		Heian period, 9-10th c.	Private collection
4-11	Standing Kōmokuten (Virupaksa)		Heian period, 10th c.	Chōmei-ji temple, Shiga
4-12	▲ Standing Tenbu (Deva)		Heian period, 10th c.	Kasuga shrine, Shiga
4-13	■ Standing Jikokuten (Dhrtarastra) and Tamonten (Vaisravana)		Heian period, 12th c.	Kōshō-ji temple, Shiga
4-14	◎ Standing Bishamonten (Vaisravana)		Heian period, ca. 1011	Seigan-ji temple, Kyoto
4-15	Fudō Myō-ō (Acalanatha) seated with One Leg Pendant		Heian period, 12th c.	Private collection
4-16	★ Standing Fudō Myō-ō (Acalanatha)		Kamakura period, 13th c.	Jizō-in temple, Saitama

No.	Title	Artist	Period	Collection
4-17	Fudō Myō-ō (Acalanatha) and Attendant Youths		Kamakura period, 13th c.	Shōmyō-ji temple, Kanagawa
4-18	Standing Fudō Myō-ō (Acalanatha)		Heian period, 11th c.	Kyoto National Museum
4-19 ◎	Standing Nyorai (Tathagata)		Heian period, 10th c.	Jakuō-ji temple, Shiga
4-20 ◎	Seated Dainichi Nyorai (Mahavairocana)		Heian period, 12th c.	Tokyo National Museum
4-21 ◎	Standing Shaka Nyorai (Shakyamuni)		Kamakura period, 13th c.	Shōgon-ji temple, Shiga
4-22	Standing Eleven-headed Kannon (Avalokitesvara)		Kamakura period, 13th c.	Shitennō-ji temple, Osaka
4-23	Bosatsu (Bodhisattva) seated with One Leg Pendent		Heian period, 9-10th c.	Tokyo National Museum

ROOM 5

5-1 ◎	Standing Kannon Bosatsu (Avalokitesvara)		Heian period, 10-11th c.	Honzan-ji temple, Osaka
5-2	Standing Kannon Bosatsu (Avalokitesvara)		Heian period, 9th c.	Private collection
5-3 ◎	Standing Eleven-headed Kannon (Avalokitesvara)		Heian period, 9th c.	Chōen-ji temple, Osaka
5-4	Five great Myō-ō (Vidya-rajā)		Heian period, 10-11th c.	Nara National Museum
5-5	Standing Twelve Divine Generals (Rat, Ox, Tiger, Rabbit, Dragon, Snake)		Kamakura period, 13th c.	Nara National Museum
5-6	Standing Guardian Deity of Temple Precincts (Garajjin)		Kamakura period, 13th c.	Nara National Museum
5-7	Standing Raijin (Thunder God)		Nambokuchō period, 14th c.	Odawara Art Foundation
5-8 ◎	Seated Shōkannon (Aryavalokitesvara)		Heian period, 11th c.	Shōgon-ji temple, Shiga
5-9	Overhead Faces of Senju Kannon (Sahasrabhuja) handed down in Sanjū-sangen-dō temple		Heian-Edo periods	Private collection

[Floor guide]

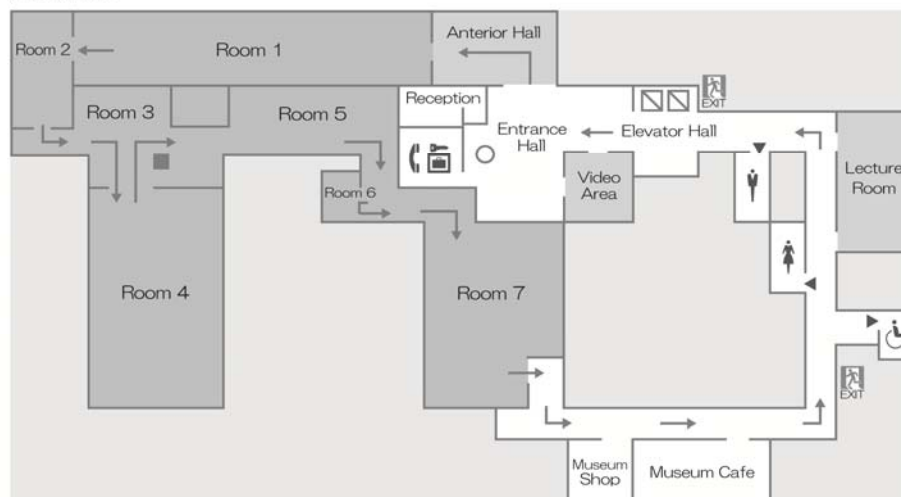

R Replica
RR Replica (Reconstruction)
R/R Replica and Reconstruction
UR Uncolored Replica
SR Structure model
RS Restoration

ROOM 6

No.	Title	Artist	Period (original)	Collection
6-1	RR Bosatsu (Bodhisattva) seated with One Leg Pendent, Hōbodai-in temple	Nakamura Tsuneyoshi	Heian period	Kōmyō-in temple, Kanagawa

ROOM 7

7-1	RR Traditionally identified as Standing Yakushi Nyorai (Bhaisajyaguru), Tōshōdai-ji temple	Miyaki Natsuki	Nara period	Private collection
7-2	R Standing Bishamonten (Vaisravana), Sekkei-ji temple	Nakamura Shino	Kamakura period	Tokyo University of the Arts
7-3	R Standing Gandharva from Eight Kinds of Mythological Beings, Kōfuku-ji temple	Konuma Shouko	Nara period	Private collection
7-4	R/R Nikkō Bosatsu (Bodhisattva Suryaprabha) seated with One Leg Pendent, Tokyo National Museum Gakkō Bosatsu (Bodhisattva Candraprabha) seated with One Leg Pendent, Tokyo University of the Arts	Shirasawa Youji	Nara period	Private collection
7-5	RR Standing Eleven-headed Avalokitesvara, Dōmyō-ji temple	Nakamura Tsuneyoshi	Heian period	Tokyo University of the Arts
7-6	UR Rat from Standing Twelve Divine Generals, Tōdai-ji temple	Suzuki Atsushi	Heian period	Private collection
7-7	RR Standing Miroku Bosatsu (Maitreya), Chūsei-in, Tōdai-ji temple	Kojima Hisanori	Kamakura period	Private collection
7-8	Structure model of Standing Miroku Bosatsu (Maitreya), Chūsei-in, Tōdai-ji temple	Kojima Hisanori	Kamakura period	Private collection
7-9	R Sheep from Standing Twelve Divine Generals, Murou-ji temple	Suzuki Atsushi	Kamakura period	Private collection
7-10	RR Standing Amida Nyorai (Amitabha), Shunjō-do, Tōdai-ji temple	Yoshimizu Kaimon	Kamakura period	Private collection
7-11	RR Standing Kongara-Dōji (Kimkara) from Eight Great Youths, Kongōbu-ji temple	Kuroyanagi Namiko	Kamakura period	Private collection
7-12	R Standing Tentō-ki Ogre, Kōfuku-ji temple	Masuda Yoshiki	Kamakura period	Tokyo University of the Arts
7-13	RR Standing Tentō-ki Ogre and Ryūtō-ki Ogre, Kōfuku-ji temple	Masuda Yoshiki	Kamakura period	Kōmyō-in temple, Kanagawa
7-14	RS Standing Jizō Bosatsu (Ksitigarbha), also known as Yonaki-jizō		Heian period	Shin-Yakushi-ji temple, Nara
7-15	RS Fudō Myō-ō (Acalanatha) and Attendant Youths		Kamakura period	Private collection

Coming up next

National Treasure *Pine Trees in the Snow* and Animals in Art December 13 - January 31, 2019