



Hina Dolls of the Mitsui Family

Thematic Exhibition

Recent Donations of Paintings, Decorative Arts and Dolls

LIST OF EXHIBITS

February 11 - April 2, 2023

 Mitsui Memorial Museum

ROOM 1

No.	Title	Artist	Period
Tomoe Symbol <i>Hina</i> Dolls and Miniature Furniture Possessed by Mitsui Motoko (wife of Takamine, 10th Head of the Kita Mitsui Family)			
H1	Set of miniature furniture (<i>Chabentō</i>) for the Doll's Festival, plum and hawk feathers crest scroll design		Edo period, 19th c.
H2	Set of miniature furniture (<i>Onna-Norimono</i>) for the Doll's Festival, plum and hawk feathers crest scroll design		Edo period, 19th c.
H3	Set of miniature furniture (<i>Koto, Shamisen</i>) for the Doll's Festival, Hollyhock and <i>Yabure-shippō</i> cloisonné crest design		Edo period, 19th c.
H4	Set of <i>Hina</i> dolls (<i>Kyōhō-bina</i>)		Edo period, 19th c.
H5	Set of silver miniature furniture		Edo-Meiji periods, 19th c.
H6	Set of miniature shelf cabinets, <i>Yoshino-yama</i> design incense utensils / toiletry articles / writing utensils	Zōhiko (Nishimura Hikobē VIII)	Meiji-Early Shōwa periods, 19-20th c.
H7	Set of <i>Hina</i> dolls (<i>Jirōzaemon-bina</i>)		Meiji period, 19-20th c.
H8	Set of <i>Hina</i> dolls (<i>Dairi-bina</i>)		Meiji period, 1884
H9	Set of <i>Hina</i> dolls (<i>Yūsoku-bina</i>)		Edo period, 19th c.
H10	Set of <i>Hina</i> dolls (<i>Dairi-bina</i>)	Ōki Heizō III	Meiji period, 1895

ROOM 2

Tomoe Symbol *Hina* Dolls and Miniature Furniture
Possessed by Mitsui **Motoko** (wife of Takamine, 10th Head of the Kita Mitsui Family)

H11	Standing <i>Hina</i> dolls		Edo period, 1815
-----	----------------------------	--	------------------

ROOM 3

T1	Single Line Calligraphy; “Sound of Water and Color of Mountain”	Takuan Sōhō	Edo period, 1617
T2	Tea Bowl, <i>Goshomaru</i> type		Choson dynasty, 17th c.
T3	<i>Katatsuki</i> Tea Caddy, named “Sazanami (“small wave”)”, <i>Zeze</i> ware		Edo period, 17th c.

No.	Title	Artist	Period
Kochō Symbol <i>Hina</i> Dolls and Miniature Furniture Possessed by Mitsui Toshiko (wife of Takakimi, 11th Head of the Kita Mitsui Family)			
H12	Set of miniature furniture for the Doll's Festival, peony scroll design pair of containers for painted-shell matching game / cabinet / large chest / chests for clothes etc.		Meiji-Taishō periods, 20th c.
H13	Set of <i>Hina</i> dolls and miniature furniture set of <i>Hina</i> dolls (<i>Dairi-bina</i> , <i>Jirōzaemon-bina</i>) / three ladies-in-waiting / five musicians / guards / attendants / dog-shaped boxes / screens / lamps with paper shade / cherry blossoms and <i>Tachibana</i> orange, etc.	Eitokusai II	Meiji-Taishō periods, 20th c.
H14	<i>Ichimatsu-ningyō</i> doll	Eitokusai II	Taishō period, 20th c.
Ei Symbol <i>Hina</i> Dolls and Miniature Furniture donated by Ms. Asano Hisako (daughter of Takakimi, 11th Head of the Kita Mitsui Family)			
H15	Ei Symbol <i>Hina</i> Dolls and Miniature Furniture		
	Set of <i>Hina</i> dolls / five ladies-in-waiting / five musicians / guard / attendants etc.	Ōki Heizō V	Shōwa period, 1934
	Set of miniature furniture for the Doll's Festival, paulownia crest scroll design shelf cabinets (incense utensils, toiletry articles, writing utensils) / cabinet / large chests / chests for clothes / clothes rack / kimono, etc.	Ōki Heizō V	Shōwa period, 1934
	<i>Hina</i> dolls in a miniature hall (<i>Shishinden</i>) for state ceremonies	Ōki Heizō V	Shōwa period, 1934
	Folding screen, cranes and peach blossoms design	Maruyama Ōshō	Shōwa period, 1934
	<i>Kochō</i> , Japanese traditional dance		Early Shōwa period, 20th c.
	Young <i>Sugawara Michizane</i> and a Japanese apricot with red blossoms	Ōki Heizō V	Early Shōwa period, 20th c.
	<i>Sōshi Arai Komachi</i> , Noh (Japanese traditional play)	Ōki Heizō V	Early Shōwa period, 20th c.
	Playing in the snow	Ōki Heizō V	Early Shōwa period, 20th c.
	<i>Gosho-ningyō</i> doll with tray (<i>Midarebako</i>) and clothes	Ōki Heizō V	Shōwa period, 1935
	<i>Gosho-ningyō</i> doll (treasure cart)	Ōki Heizō V	Early Shōwa period, 20th c.
	<i>Gosho-ningyō</i> doll (sea bream cart)		Early Shōwa period, 20th c.
	<i>Gosho-ningyō</i> doll (sea water carrier)		Early Shōwa period, 20th c.
	<i>Gosho-ningyō</i> doll (<i>Ebisu</i>)		Early Shōwa period, 20th c.
	<i>Gosho-ningyō</i> doll (bag carrier)	Ōki Heizō V	Early Shōwa period, 20th c.
Tama Symbol <i>Hina</i> Dolls and Miniature Furniture Possessed by Mitsui Okiko (wife of Takahisa, 9th Head of the Isarago Mitsui Family / daughter of Takamine and Motoko)			
H16	Set of <i>Hina</i> dolls and miniature furniture set of <i>Hina</i> dolls / three ladies-in-waiting / five musicians / guards / attendants / screens / lamps with paper shades / cherry blossoms and <i>Tachibana</i> orange, etc.	Ōki Heizō IV	Meiji period, 1900
H17	Court Lady		Meiji period, 20th c.
H18	Beauty holding flower basket		Meiji period, 20th c.
H19	Standing beauty	Ōki Heizō IV	Meiji period, 1909
H20	<i>Hōkoku</i> dance	Ōki Heizō IV	Meiji period, 1898
H21	Playing children		Meiji period, 20th c.
Special Display			
SD	Pair of containers (<i>Kaioke</i>) for painted-shell		Edo period, 19th c.

ROOM 5

No.	Title	Artist	Period
H22	<i>Gosho-ningyō</i> doll		Edo period, 1858
H23	<i>Gosho-ningyō</i> doll		Edo period, 19th c.
H24	<i>Gosho-ningyō</i> doll		Edo period, 19th c.
H25	<i>Gosho-ningyō</i> doll, <i>Daikoku</i>	Ōki Heizō V	Meiji-Taishō period, 20th c.
H26	<i>Gosho-ningyō</i> doll, <i>Ebisu</i>		Early Shōwa period, 20th c.
H27	<i>Gosho-ningyō</i> doll, child on sea bream		Early Shōwa period, 20th c.
H28	<i>Gosho-ningyō</i> doll, flower cart	Ōki Heizō V	Early Shōwa period, 20th c.
H29	<i>Gosho-ningyō</i> doll, piper	Shumpo	Early Shōwa period, 20th c.
H30	Box, <i>Gosho-ningyō</i> doll design	Gyokusui	Early Shōwa period, 20th c.
H31	<i>Gosho-ningyō</i> dolls, the battle of Uji	Ōki Heizō V	Shōwa period, 1933
H32	<i>Gosho-ningyō</i> dolls, wooden horse and children	Ōki Heizō V	Shōwa period, 1933
H33	<i>Gosho-ningyō</i> dolls, portable shrine	Ōki Heizō V	Shōwa period, 1933
H34	<i>Gosho-ningyō</i> dolls, feudal lord's procession	Ōki Heizō V	Shōwa period, 1933
H35	<i>Gosho-ningyō</i> doll	Ōki Heizō V	Early Shōwa period, 20th c.

ROOM 6

D1	<i>Kōge Bachiru no Bachi</i> : A pick made of ivory, Restoration of Ancient carving in ivory	Muramatsu Shingetsu	Heisei period, 20-21th c.
D2	<i>Ryokuge Bachiru no Shaku</i> : A shaku ruler made of ivory, Restoration of Ancient carving in ivory	Muramatsu Shingetsu	Heisei period, 20-21th c.
D3	<i>Kōge Bachiru no Shaku</i> : A shaku ruler made of ivory, Restoration of Ancient carving in ivory	Muramatsu Shingetsu	Heisei period, 20-21th c.
D4	<i>Kōge and Konge Bachiru no Kishi</i> : Go stones, Restoration of Ancient carving in ivory	Muramatsu Shingetsu	Heisei period, 20-21th c.
D5	Old Fisherman	Ryūmin	Meiji-Taishō periods, 20th c.
D6	Cabinet for <i>Hyakunin-Isshū</i> with Pine, Bamboo and Plum Tree Design		Edo period, 17th c.
D7	Comb and Hairpin with <i>Gagaku</i> (Ancient Japanese court music) and Cranes design in <i>Maki-e</i>	Hakuju, and Yōsai	Meiji-Taishō periods, 20th c.
D8	A cat	Hamaguchi Yōzō	Shōwa period, 20th c.
D9	Red and White plum tree	Okumura Togyū	Shōwa period, 20th c.
D10	Cranes	Dōmoto Inshō	Shōwa period, 20th c.

Mitsui Memorial Museum

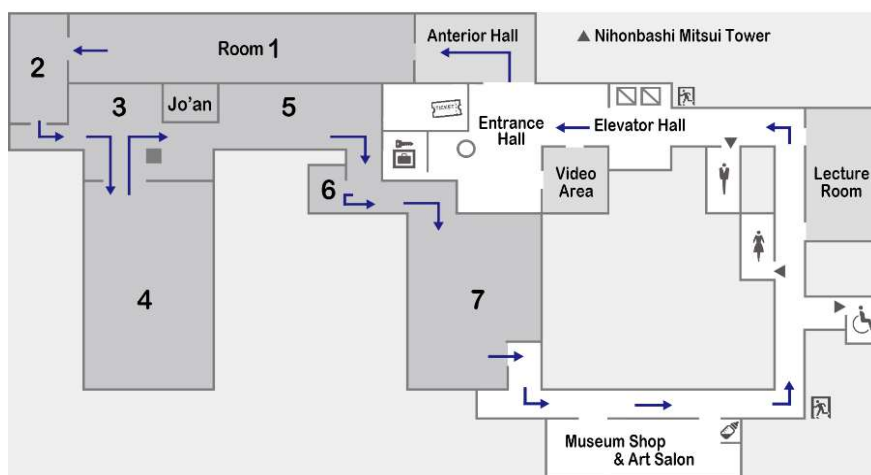

No.	Title	Artist	Period
D11	Inkstone Box with Fan Design in <i>maki-e</i>	Rokkaku Shisui	Meiji-Shōwa periods, 20th c.
D12	Inkstone Box with wave design	Designed by Mitsui Takamine	Shōwa period, 20th c.
D13	Inkstone box with “ <i>Ryōgae Nendai-ki</i> ” Design in <i>Maki-e</i>	Zōhiko (Nishimura Hikobē VIII)	Shōwa period, 20th c.
D14	Incense Burner with Pigeon and Cane decoration, Purple <i>Kōchi</i> style		Shōwa period, 1936
D15	Flower Vase with Handles in Overglaze Enamels on a Red ground, with “Fuku-Ju” Calligraphy	Calligraphy of “Fuku-Ju” by Mitsui Takamine	Shōwa period, 1943
D16	Tea Bowl with Paulownia Design in Overglaze Enamels	Designed by Mitsui Takamine	Shōwa period, 1943
D17	Japanese Sweets Dish with Mount <i>Ōyama</i> Painting Design	Designed by Mitsui Takamine	Shōwa period, 1939
D18	<i>Jutai-chō</i> (A kind of Paradise Flycatcher) on the Plum tree	Mitsui Takasumi	Taishō period, 1917
D19	The Seven Gods of Good Fortune	Mitsui Takayoshi	Edo period, 1864
D20	Landscape of Mount <i>Kawara</i>	Mitsui Takamine	Taishō period, 1917
D21	Landscape of <i>Rinsui-An</i>	Mitsui Takamine	Shōwa period, 1936
D22	Landscape with ink broken	Mitsui Takamine	Shōwa period, 1944
D23	Empress Jingū and Takeshiuchi-no-Sukune	Made by Mitsukoshi	Shōwa period, 20th c.
D24	<i>Kazari-Uma</i> (Decorated Horse), Based on Ancient Practices and Usages		Early Shōwa period, 20th c.
D25	Helmet on Stand		Early Shōwa period, 20th c.
D26	Japanese Cavalry Warrior Doll	Eitokusai	Meiji-Taishō periods, 20th c.
D27	Ya-no-ne Gorō (Soga Gorō, The Character of <i>Kabuki</i> , “ <i>Ya-no-ne</i> ”)		Early Shōwa period, 20th c.
D28	Palace Doll Tugging a Tiger		Early Shōwa period, 20th c.
D29	<i>Mitsui-Gonomi</i> , <i>Miyako-no-Nishiki</i> (women's contemporary fashion)	Mizuno Toshikata	Meiji period, 20th c.
D30	A Trace of “ <i>Waka</i> ”	Emperor Gomizu-no-o	Edo period, 17th c.
D31	Birds and Flowers	Watanabe Shikō	Edo period, 18th c.
D32	Cherry-blossom Viewing	Kawanabe Kyōsai	Meiji period, 19th c.
D33	Thunderstorm	Attributed to Maruyama Ōkyo	Edo period, 18th c.
D34	A portrait of Karai Senryū	Hasegawa Tōsetsu	Edo period, 1832
D35	Java sparrow and Banana plant	Mitsui Takanori	Shōwa period, 1933
D36	<i>Maki-e</i> lacquered Sliding door with gold-lacquer design of spring fields	Hara Yōyūsai, sketch by Sakai Hōitsu	Edo period, 19th c.